

# The Village Shoppes of North Reading



## The Village Shoppes of North Reading

303 Main Street - Route 28 North  
North Reading / Andover Line

*Coming Fall of 2008*

**22,000 SF Retail/Office Space, Two Levels**

\*First level has 2400 sf end cap with drive thru,  
7200 sf commercial space and 5100 sf end cap (Perfect for a restaurant)

**FULL LIQUOR LICENSE AVAILABLE**

\*Additional 7200 sf professional or retail space is available  
on the second level with full elevator accessibility

***Vanilla Shell Plus / Custom Size Units Possible***



*Prospective tenants should contact the Developer:*

**Pat Buonopane**

**617-628-4900**

*Email: [patb@cldboston.com](mailto:patb@cldboston.com)*

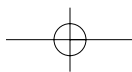

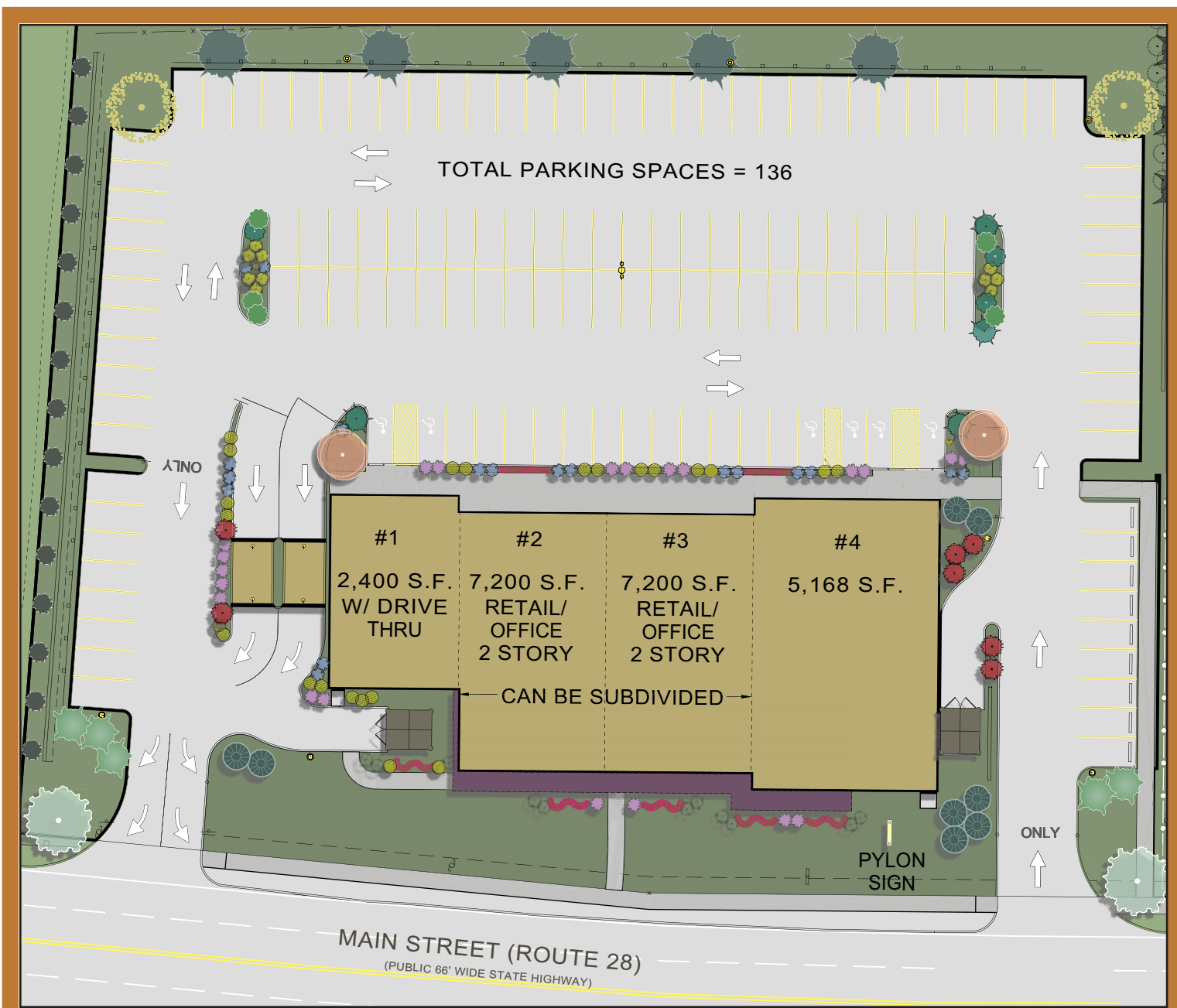
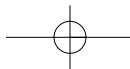

*Prospective tenants should contact the Developer:*

**Pat Buonopane**  
**617-628-4900**

**Email: patb@cldboston.com**

